

PortNAT TB Assay



The Need

- In 2022, an estimated 10.6 million people worldwide developed tuberculosis, with an incidence rate of 133 per 100,000 population^[1].
- In 2022, 6.2 million cases of pulmonary tuberculosis were diagnosed globally, of which 37% were not confirmed bacteriologically^[1].
- TB caused 1.3 million deaths globally in 2022, nearly double the deaths caused by HIV/AIDS^[1].
- Early and accurate detection of TB is essential for improving case management and significantly preventing transmission.

Ongoing Challenges

1

In resource-limited settings, the lack of advanced diagnostic technologies delays accurate testing, leading to delayed treatment and misdiagnosis.

2

Traditional TB diagnostic methods, like sputum, smears and cultures, take too long, delaying treatment and increasing transmission risk.

3

Outdated infrastructure in low- and middle-income countries hampers large-scale TB testing due to old equipment, insufficient training, and supply chain issues.

4

Diagnosing TB in children is challenging due to the inability to produce sputum, low bacterial load, and reliance on non-specific clinical signs, which often leads to delayed diagnosis and treatment.

5

Molecular POCT offers rapid results, but high costs and operational complexity limit its widespread use in many regions.

The Solution

PortNAT TB Assay provides the convenience of on-demand testing with rapid and precise results. Key benefits include:

- High-quality results within approximately 30 minutes
- Ability to perform testing anytime, anywhere
- Less than 1 minute of handling time, with no specimen preparation required
- Utilize a power bank for operation in locations without electrical supply
- Supports ambient temperature transportation

PortNAT TB Assay, conducted on Ustar's PortNAT® system, ensures accurate results, simplifies the testing process, and offers the flexibility to deliver results when and where they are needed to meet timely testing demands.



The Impact

PortNAT TB Assay delivers on-demand testing with point-of-care results within approximately 30 minutes, allowing healthcare providers to offer care and treatment directly at the point of need.

- 1** Accelerating diagnosis and treatment to improve workflow effectiveness.
- 2** Rapidly detecting possible cases to minimize the risk of community transmission.
- 3** Cutting down on staff time and training demands.
- 4** Offering timely insights to guide vaccination and prevention efforts.

Workflow

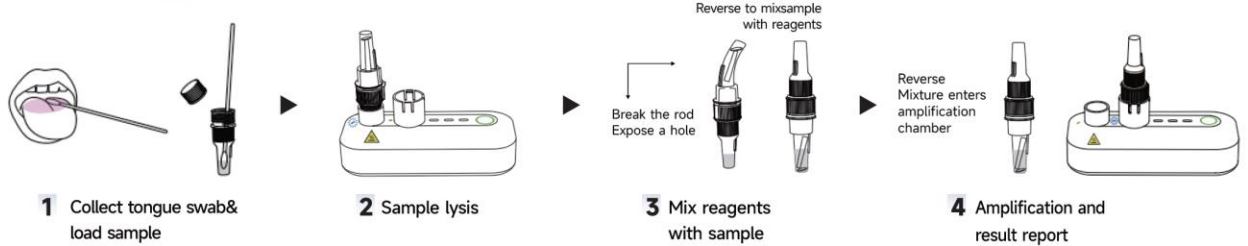

Performance

Specificity	93.30%	Overall percent agreement	96.80%
Sensitivity	100.00%	LOD for the assay is	400 CFU/mL

Product	PortNAT TB Assay	Shelf life	12 months
Sample type	Tongue Swab	Storage conditions	2-8°C
Specification	20 Tests/box	Transport conditions	Ambient
Applicable instrument	PortNAT Molecular Analyzer		

[1]Global Tuberculosis Report 2023.

Exclusive Distributor of eHealthCare Solutions:

**ANALOG TEST AND MEASUREMENT
PHILIPPINES INC.**

Unit 307, Civic Prime Building, Filinvest City
Alabang Muntinlupa City.

Manila Line: (02) 8881-9669 / (02) 8883-8325 / 09175240067

E-mail: r.candelaria@atmpinc.com

How PortNAT works with Cloud Server

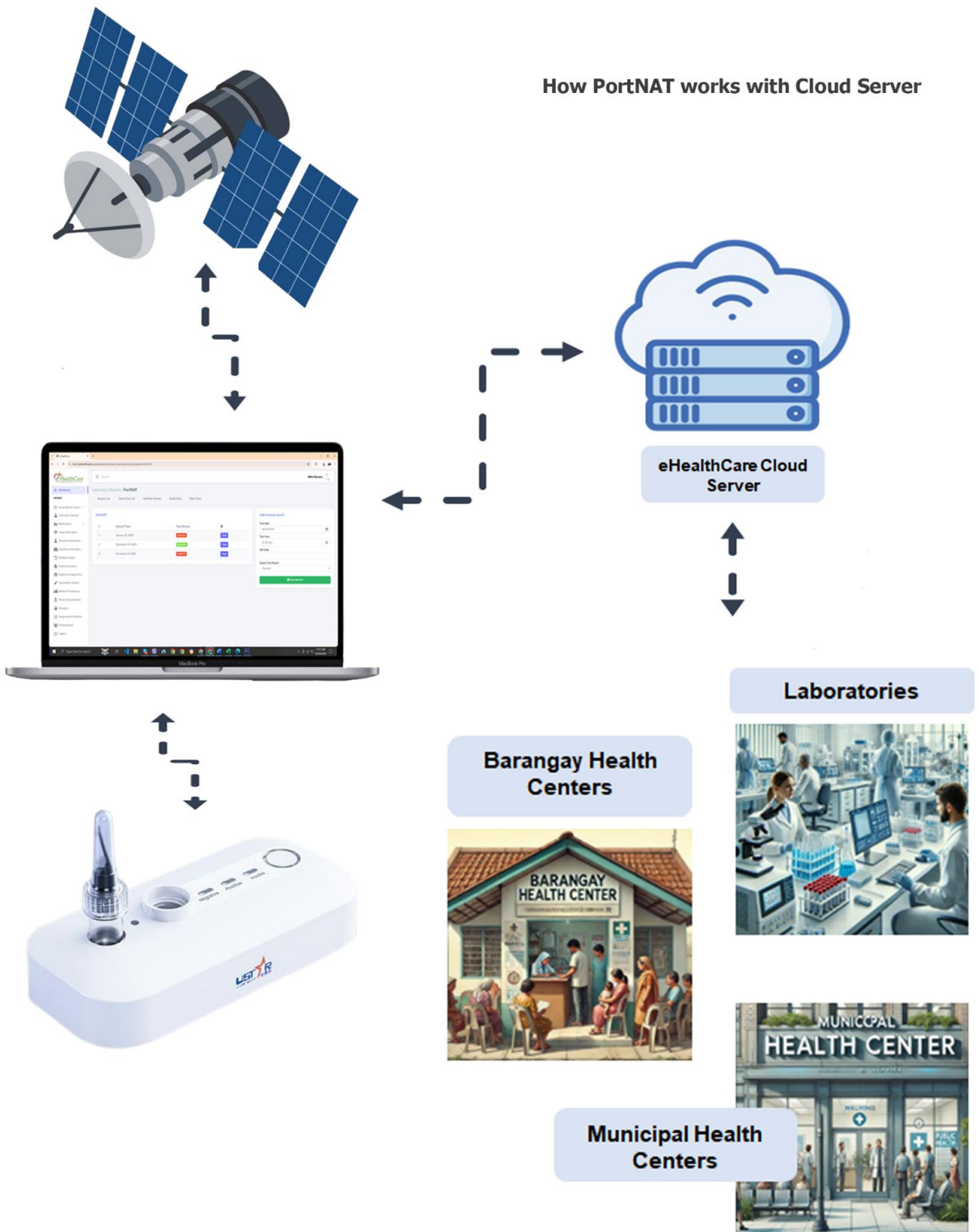

Exclusive Distributor of eHealthCare Solutions:

ANALOG TEST AND MEASUREMENT PHILIPPINES INC.

Unit 307, Civic Prime Building, Filinvest City
Alabang Muntinlupa City.

Manila Line: (02) 8881-9669 / (02) 8883-8325 / 09175240067

E-mail: r.candelaria@atmpinc.com